

SECTION SOUTH 1
SECTION SOUTH 2

SECTION SOUTH 1

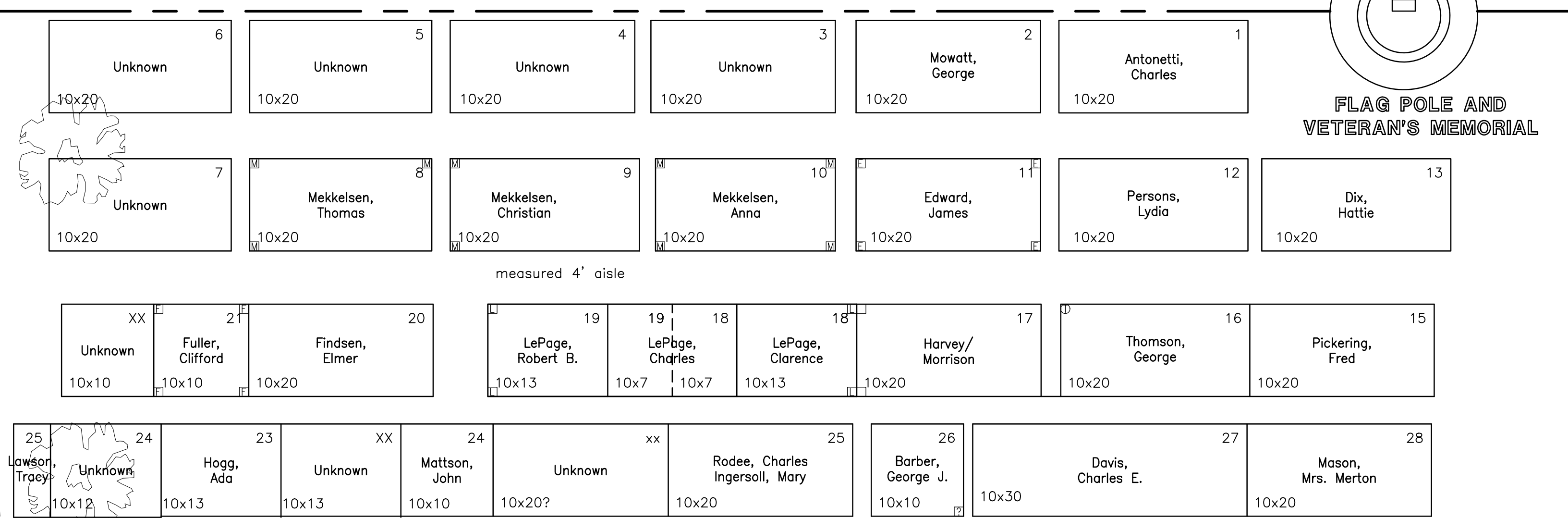

UNUSED GATE

~ GRASSED PATHWAY ~

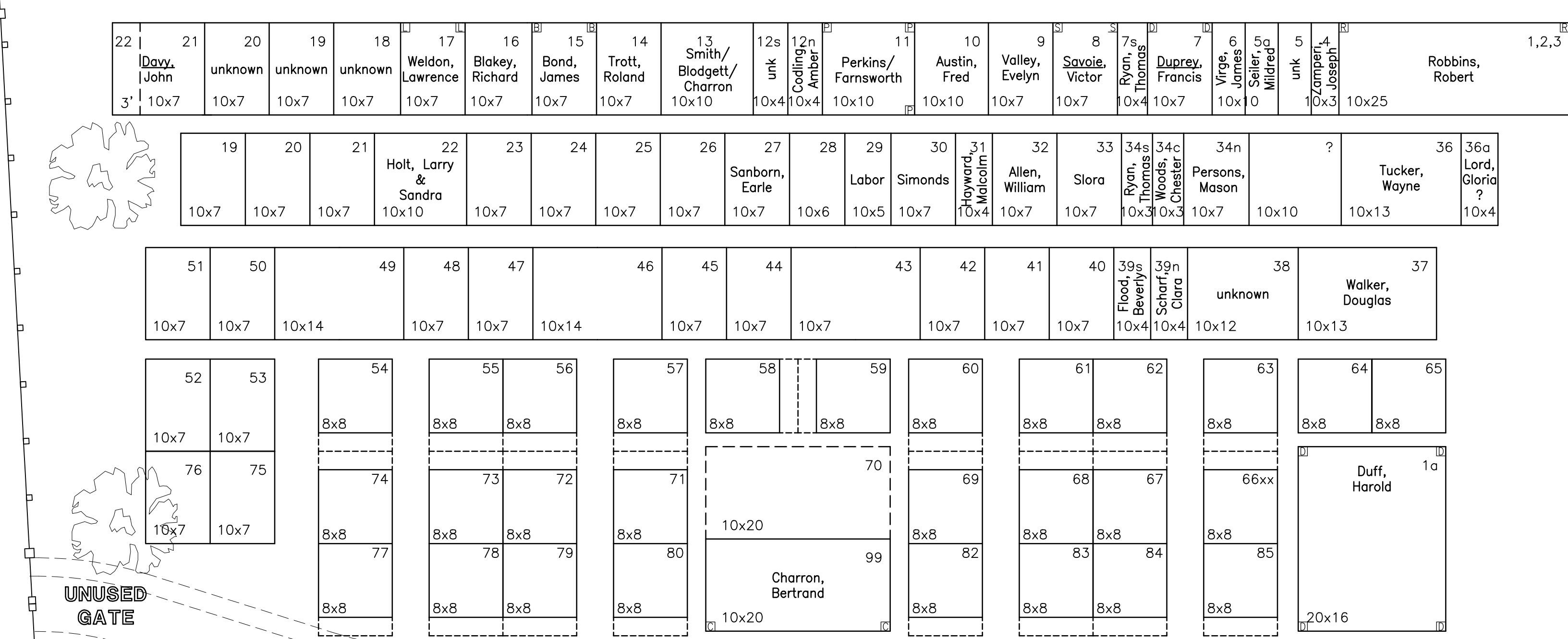

UNUSED GATE

SECTION SOUTH 2

GRASSED PATHWAY

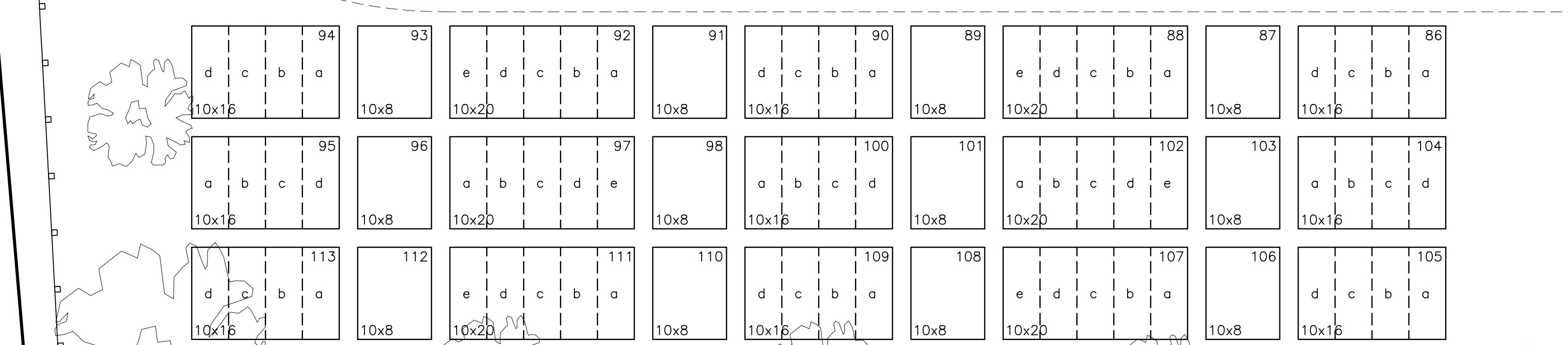

MAIN GATE

TO FARWELL STREET

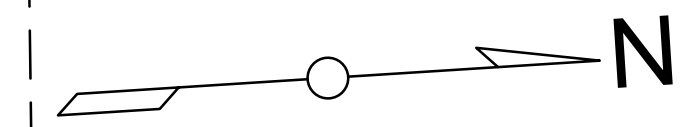
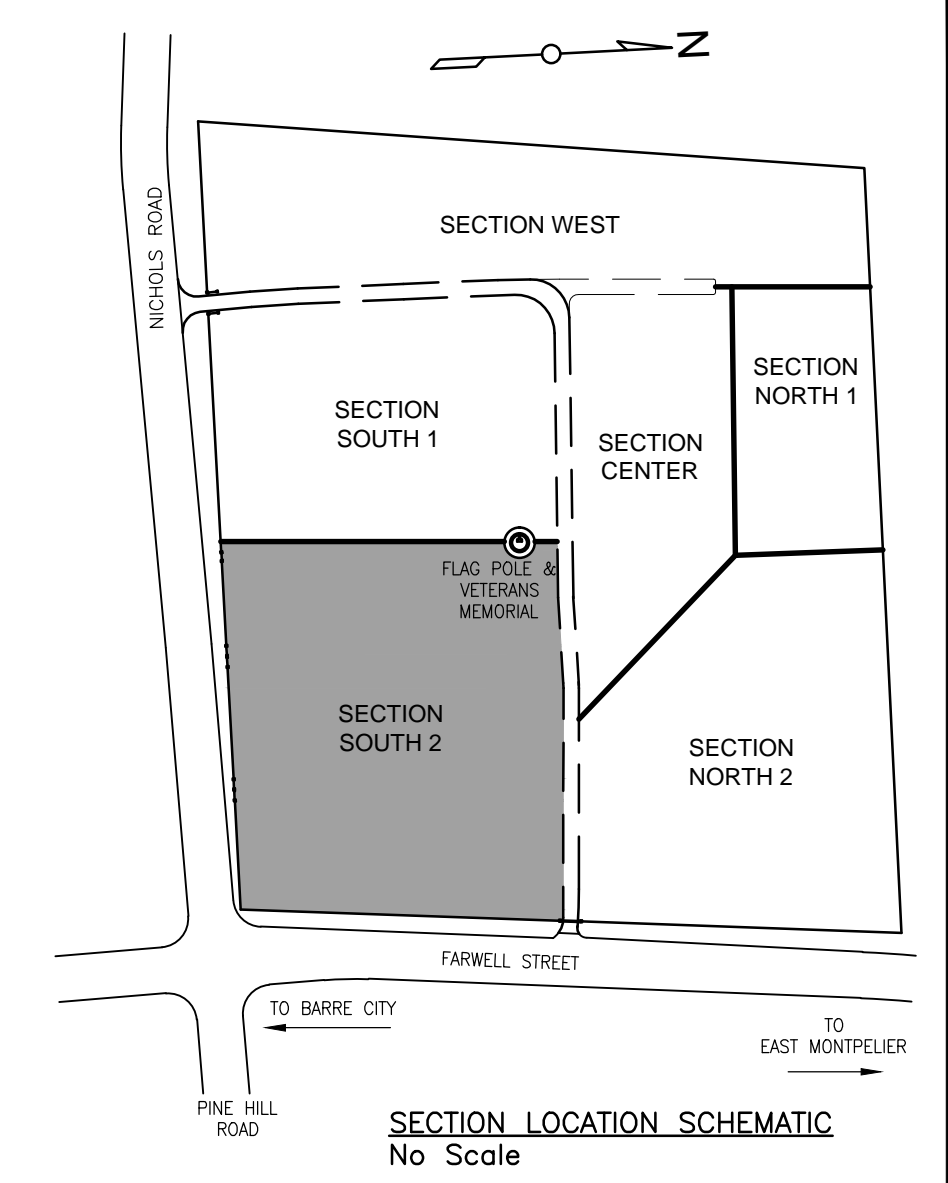

SECTION CENTER

GRAVEL DRIVEWAY

SECTION NORTH 2

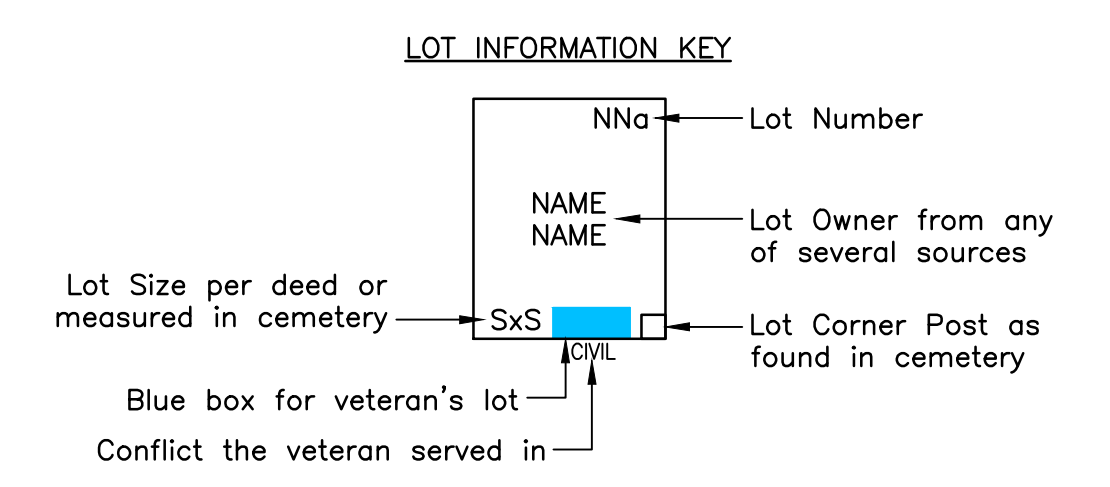

- NOTES:
- IF A WHOLE LOT SHOWN IS DIVIDED AND SOLD AS TWO SMALLER LOTS, USE THE LOT NUMBER SHOWN PLUS THE IDENTIFIER "s" FOR THE SOUTHERNMOST LOT AND THE IDENTIFIER "n" FOR THE NORTHERNMOST LOT. EXAMPLE: IF LOT 46, SHOWN AS 10x14 ON THE PLAN, WAS DIVIDED INTO TWO LOTS OF 10x7 EACH, THE LOT TO THE SOUTH WOULD BE 46s AND THE LOT TO THE NORTH, 46n.
 - THE LARGE 10x20 LOTS SHOWN IN SECTION SOUTH 2 CAN BE BROKEN UP AND SOLD AS SINGLE 10x4 LOTS. THE LOT NUMBERS USED WOULD INCLUDE THE LETTER DESIGNATIONS SHOWN BETWEEN THE DASHED LINES. EXAMPLE: IF LOT 88 WAS DIVIDED INTO FIVE SINGLE GRAVE LOTS, THE NEW LOT DESIGNATIONS WOULD BE 88a, 88b, 88c, 88d, AND 88e.
 - THE 8' x 8' LOTS SHOWN ARE INTENDED FOR COLUMBARIA STYLE FAMILY MONUMENTS. THE FAMILY COLUMBARIUM WILL BE CENTERED WITHIN THE LOT. THE ONLY OTHER MARKERS ALLOWED IN THE LOTS ARE GRASS MARKERS LAID FLUSH TO THE GROUND. SEE RULES AND REGULATIONS DOCUMENT FOUND ON THE BARRE TOWN WEBSITE FOR FURTHER DETAILS.
 - SHOULD IT BECOME NECESSARY AND THE SALES OF 8' x 8' LOTS BECOME INCONSEQUENTIAL, THE CEMETERY COMMISSION MAY AUTHORIZE THE ADJUSTMENT OF SEVERAL OF THE 8' x 8' LOTS INTO 8' x 10' FULL BURIAL LOTS AS FOLLOWS:
 LOTS 54-57, 60-63: ADD 2' FROM THE AISLE ON THE EAST
 LOTS 66-69, 71-74: ADD 2' FROM THE AISLE ON THE WEST
 LOTS 77-80, 82-85: ADD 2' ON THE EAST SIDE
 LOTS THAT REVERT TO THE FULL BURIAL LOTS WILL NO LONGER HAVE THE FAMILY MONUMENT SET AT THE CENTER OF THE LOT BUT AT THE HEAD OF THE LOT AS DIRECTED BY THE SEXTON.

PLAN ADOPTED: 22 AUGUST 2018
 REVISION NUMBER:
 PLAN REVISED:
 PLAN RE-ADOPTED:

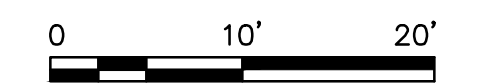

MAPLEWOOD CEMETERY
 BARRE TOWN, VERMONT
 Section South 2 Schematic
 Cemetery Year 2017